

DENISON

Engineering Division

American Brake Shoe Company Columbus 16, Ohio

installation and service information

Multipress Control Valves

MODELS C01 & C101

MODEL C01

The model C01 valve is a simple, spring offset, four-way directional control valve. It is operated either with hand, foot pedal or electric solenoid controls. When the valve spool is shifted to such a position that the pressure port of the valve is connected to the top cylinder port, the ram moves downward. The oil being forced out of the bottom cylinder port is then routed through the valve and back to tank.

When the handles are released or the solenoid de-energized, the spool is returned to its spring offset position. The pressure is then routed to the bottom cylinder port and the tank and top cylinder ports are connected.

Once the ram has returned to its "up" position and contacted the upper stop collar, the valve is shifted to centered position, opening all ports to tank.

MODEL C101

Same as C01 except used with presses incorporating hydraulic pumps with delivery of less than 5 gpm.



SERVICE TIPS

A. Press overheats.	<ol style="list-style-type: none"> 1. Lower the upper stop collar. 2. Excessive hold down under pressure will also cause overheating.
B. Ram return slow to "up" position.	<ol style="list-style-type: none"> 1. Check lower stop collar. Be sure shipper rod collar does not contact frame at bottom when handles are released. Shipper rod could also be binding in frame.
C. With dual hand tie-up, ram descends with one handle.	<ol style="list-style-type: none"> 1. Adjust shipper rod into valve.
D. Leaks around spool either at top or bottom of valve.	<ol style="list-style-type: none"> 1. Remove spool from valve and replace "O" rings after breaking all sharp edges on spool.
E. Spool sticks in valve.	<ol style="list-style-type: none"> 1. Remove spool and polish with crocus cloth.
F. Ram hits collar at top of stroke and vibrates, moving up and down at a rapid rate of speed.	<ol style="list-style-type: none"> 1. Weights in excess of 50 pounds on ram can be the cause. Lighten top die shoe. 2. Slot hole at lower end of shipper rod where pin for handles is inserted.

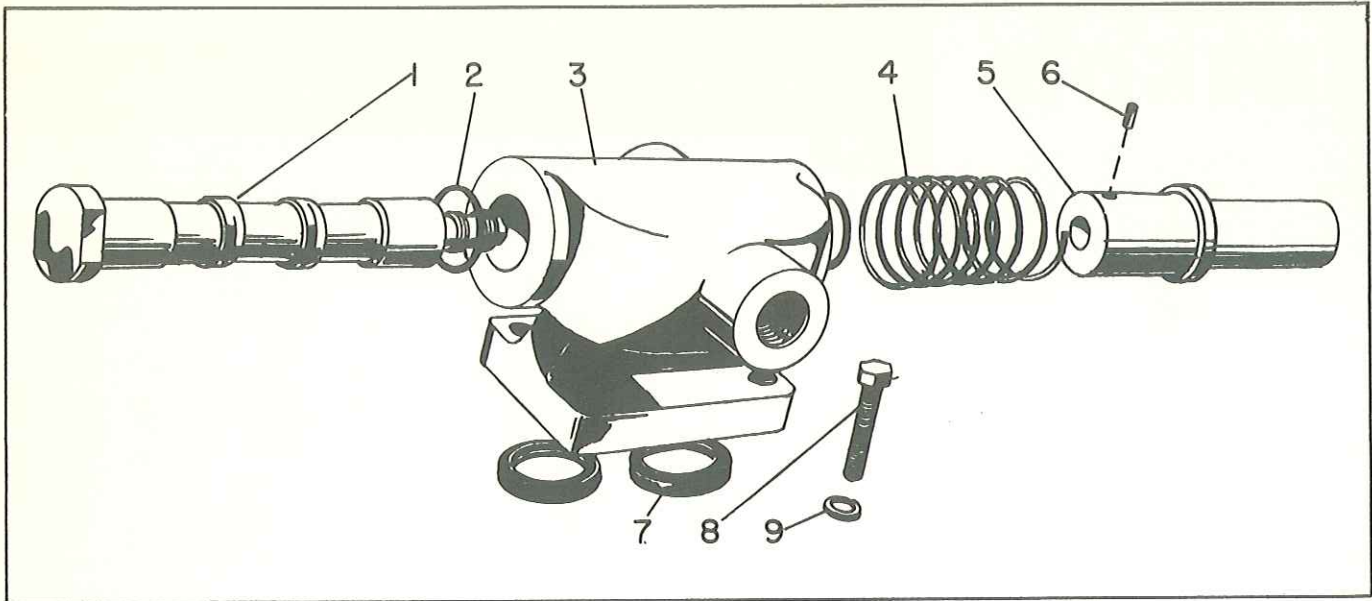

PARTS LIST

CONTROL VALVES MODELS C01, C101

Item	Part Number	Description	Quantity
1	35-10002-Z	Spool—Valve	1
2	601-02719	"O" ring (6227-19) 671-00214	2
3	35-10001-X	Body—Valve	1
4	736-08015	Spring—Compression 031-22386	1
5	35-10003-Z	Retainer—Spring	1
6	311-12060	Screw—Set, soc cup pt, (1/4-20 NC x 3/8 in. 1 g)	1
7	630-42305	Seal—Oil (42305)	2
8	306-16160	Screw—Cap, hex hd, (3/8-16 NC x 1 in. 1 g)	4
9	346-10024	Washer—Lock, (3/8 in.)	4

REPAIR KIT RK-022 011-23251